

US10-C Series

Time & Attendance terminal with 3 TFT display



US10C-R / US10C-B / US10C-M / US10C-ID is an innovative standalone RFID / barcode / magnetic stripe / Fingerprint time and attendance reader. With a color 3 inch TFT display, offering unparalleled performance on an embedded Linux platform with all the features a modern time and attendance reader should have including relay contacts for access control/external bell.

US10C series is an easy plug-in solution for existing time attendance software developers who have already integrated other ZK readers.

Features

- Choice of Barcode, Mag Stripe, Proximity or Fingerprint in same device
- 3" color TFT screen for display of graphics and icons. Managers can even leave SMS messages behind for employees reporting in/out of work
- Supports both hard-wired TCP/IP and optional wireless connections. Standard RS-232 and USB host for data downloading.
- Rugged keypad with 4 additional function keys to customize
- Built-in scheduler and relay contact can even ring an external bell/alarm. The relay can also be connected to a door strike/lock.
- Supports up to 5,000 fingerprint templates or 10,000 cards/badges
- All models support up to 100,000 transactions
- US10 Series readers optionally add internal Wi-Fi, HID Prox,, HID iClass and Mifare modules
- Free SDK is available for software developers who wish to integrate ZK readers with any application which requires verifying people

Specifications

	US10C-R	US10C-B	US10C-M	US10C-ID
External bell / alarm support	Yes			
Voice prompt	Yes			
Languages	ENGLISH/SPANISH/FRENCH			
Visual prompt	LED (GREEN/RED)			
Operating System	EMBEDDED LINUX			
Bar code cards (3 of 9) or (2 of 5)	NO	YES	NO	NO
Magnetic stripe cards (track II)	NO	NO	YES	NO
125 KHz ID prox card	STANDARD	NO	NO	STANDARD
Fingerprints	NO	NO	NO	YES
Card capacity	10.000			
Fingerprint templates capacity	N/A		5.000	
Transaction logs	50.000			
Serial Com./ for printer	YES			
TCP/IP / for network	YES			
USB	YES	NO	NO	YES
Wi-Fi	YES (Optional)			
Relay contact / for external bell/alarm	1			
Display	3" color TFT screen			
Function keys	4			
SMS	YES			
Operating Temperature/Humidity	32-113 °F (0-45 °C) 20% to 80%			
Dimmensions	13,97 (H) x16,51 (W) x 40,57 (D) CM			
Weight	1.35 KGS			
Power Adapter	12V DC, 1.5A			

Configuration

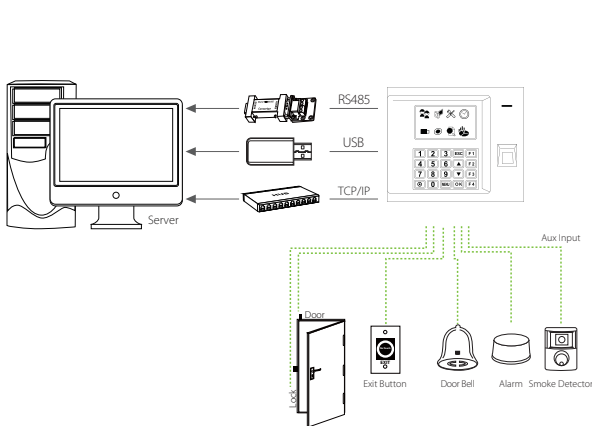

What's in the Box

